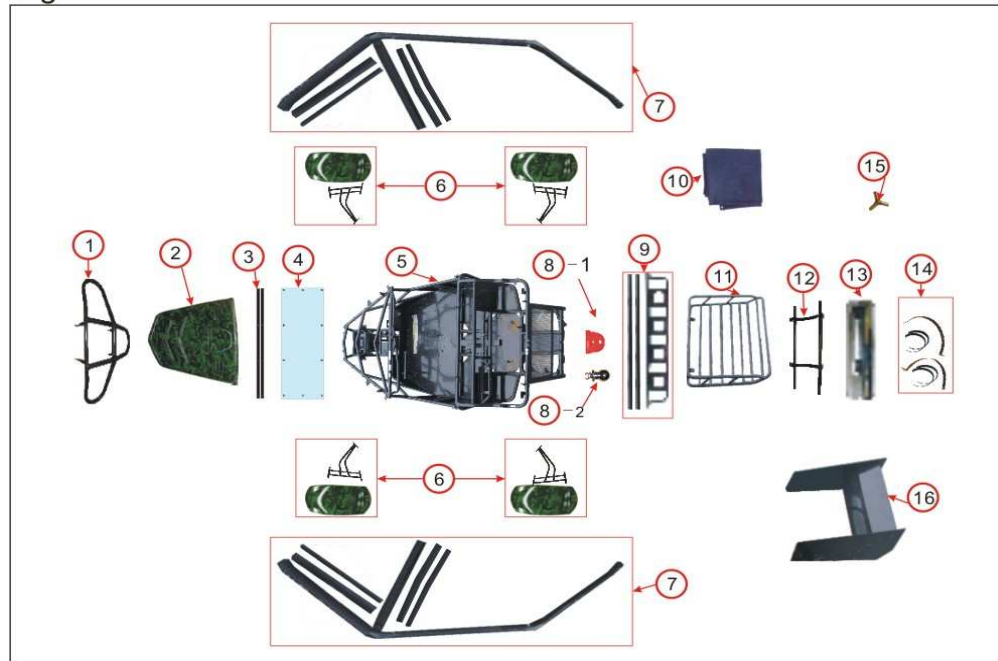
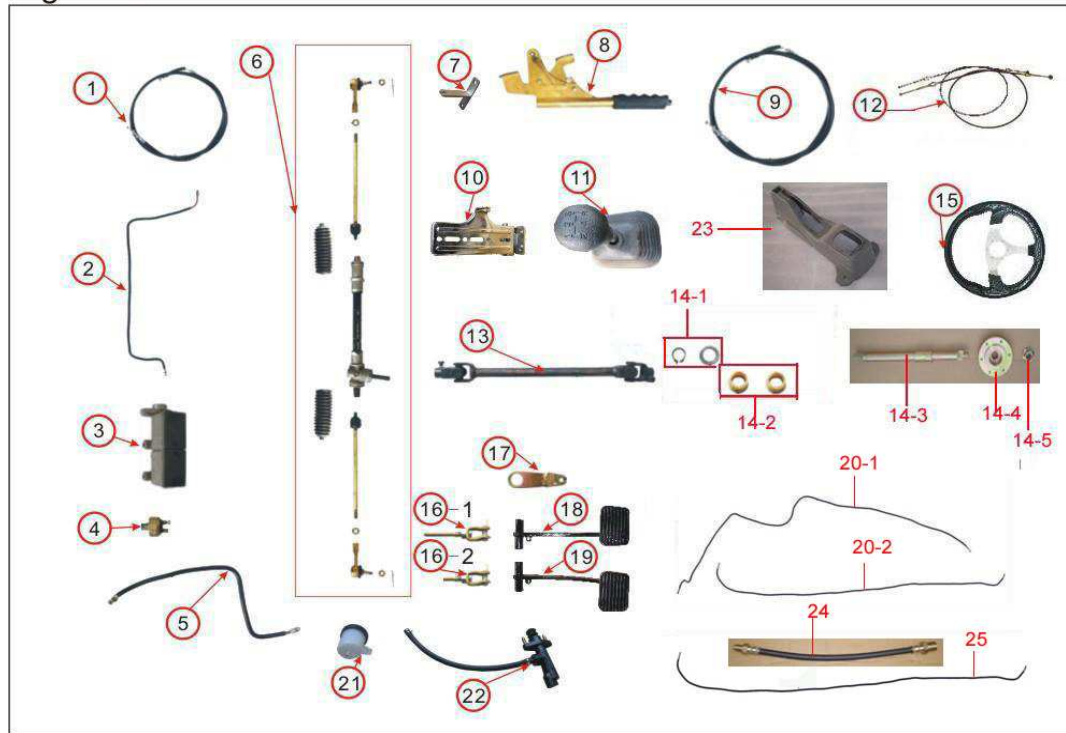

Figure 1



	PART#	CHINESE NAME		STANDARD PART	unit	PUBLIC EURO TTC
1	1100-2E-1-1	保险杠	Bumper		pcs	€ 72
2	1100-2E-1-2	前盖	front cover		pcs	€ 375
3	1100-2E-1-3	挡风玻璃固定支架	wind shield fix bracket		set	€ 29
4	1100-2E-1-4	挡风玻璃	wind shield		pcs	€ 191
5	1100-2E-1-5	主车架	MAIN FRAME		pcs	€ -
6	1100-2E-1-6-1	前后保险杠(颜色)	Front and rear fenders (color)		set	€ 159
	1100-2E-1-6-2	前后保险杠支架	Front and rear fenders bracket		set	€ 125
7	1100-2E-1-7-1	滚笼	Roll cage		set	€ 164
	1100-2E-1-7-2	保护罩	protecting jacket		pcs	€ 7
8	1100-2E-1-8-1	固定拖球板的板	the plate to fix the tow ball		pcs	€ 42
	1100-2E-1-8-2	拖球	tow ball		pcs	€ 30
9	1100-2E-1-9	交叉滚笼	cross roll cage		set	€ 136
10	1100-2E-1-10	装饰布	DECORATIVE CLOTH		pcs	€ 41
11	1100-2E-1-11	支架	rack		pcs	€ 222
12	1100-2E-1-12	燃油箱固定支架	fuel tank fix bracket		pcs	€ 70
13	1100-2E-1-13	燃油箱	fuel tank	燃油箱	pcs	€ 281
14	1100-2E-1-14	夹子和橡胶固定燃油箱	clip and rubber to fix the fuel tank		set	€ 44
15	1100-2E-1-15	燃油箱(燃油箱)	joint (Fuel tank)		pcs	€ 4
16	1100-2E-1-16	扰流板	spoiler		set	€ 222

Figure 2



	PART#	CHINESE NAME		STANDARD PART	unit	PUBLIC EURO TTC
1	1100-2E-2-1	□□□	THROTTLE CABLE		pcs	€ 21
2	1100-2E-2-2	□□□□□□□□□□	COPPER TUBE, R.FR.HYDRAULIC BRAKE		pcs	€ 15
3	1100-2E-2-3	□□□□	CHIEF PUMP, HYDRAULIC BRAKE		pcs	€ 48
4	1100-2E-2-4	□□□□□	ON-OFF, BRAKE LIGHT		pcs	€ 4
5	1100-2E-2-5	□□□□□□□□□□	COPPER TUBE, L.FR.HYDRAULIC BRAKE		pcs	€ 9
6	1100-2E-2-6	□□□□□	REDIRECTOR ASSY		set	€ 196
7	1100-2E-2-7	□□□□□□	FIXING BLOCK, THROTTLE CABLE		pcs	€ 4
8	1100-2E-2-8	□□□□	STOP BRAKE HANDLE		pcs	€ 16
9	1100-2E-2-9	□□□□EEC□□□□3□□	STOP BRAKE CABLE		set	€ 85
10	1100-2E-2-10	□□□□	THROTTLE PEDAL		pcs	€ 48
11	1100-2E-2-11	□□□□□	SHIFT HANDLE		set	€ 68
12	1100-2E-2-12	□□□□	shifter pipe		set	€ 88
13	1100-2E-2-13	□□□□□	GIMBAL		pcs	€ 50
14	1100-2E-2-14-1	□□□□□□□□	CIRCLIP & PLAIN WASHER ,STEERING POLE		set	€ -
	1100-2E-2-14-2	□□□□□□□□	NYLON BUSH, STEERING POLE		set	€ -
	1100-2E-2-14-3	□□□□	STEERING POLE		pcs	€ 65
	1100-2E-2-14-4	□□□□□□□			pcs	€ -
	1100-2E-2-14-5	□□□□□□□□□□			pcs	€ -
15	1100-2E-2-15	□□□□	STEERING WHEEL		pcs	€ 64
16	1100-2E-2-16-1	□□□□□□□	CONNECTOR, BRAKE MANDRIL		pcs	€ 9
	1100-2E-2-16-2	□□□□□□□□	clutch mandril		pcs	€ 9
17	1100-2E-2-17	□□□□□□□□	hand brake cable rocker		pcs	€ 7
18	1100-2E-2-18	□□□□	brake pedal		pcs	€ 45
19	1100-2E-2-19	□□□□□	clutch pedal		pcs	€ 45
20	1100-2E-2-20-1	□□□□□□□□□□	COPPER TUBE, R. RR. HYDRAULIC BRAKE		pcs	€ 37
	1100-2E-2-20-2	□□□□□□□□□□	COPPER TUBE, L. RR. HYDRAULIC BRAKE		pcs	€ 45
21	1100-2E-2-21	□□□□□□□□□□	oil cup(master clutch pumper)		pcs	€ 11
22	1100-2E-2-22	□□□□□	master clutch pumper		pcs	€ 96
23	1100-2E-2-23	□□□□	Box		pcs	€ -
24	1100-2E-2-24	□□□□□L=330mm	TUBE, clutch pumper		pcs	€ -
25	1100-2E-2-25	□□□□□	COPPER TUBE, clutch pumper		pcs	€ -

Figure 3



	PART#	CHINESE NAME	STANDARD PART	unit	PUBLIC EURO TTC
1	1100-2E-3-1	□□□□□EEC□	L/R.REAR MIRROR	set	€ 30
2	1100-2E-3-2	□□□EEC□	HORN	pcs	€ 23
3	1100-2E-3-3	□□□□□□EEC□	FR.L/R. TURNING LIGHT ASSY	set	€ 36
4	1100-2E-3-4	□□	winch	set	€ 176
5	1100-2E-3-5	□□□□EEC□	HEAD LIGHT ASSY	pcs	€ 43
6	1100-2E-3-6	□□□EEC□	DECORATE LIGHT ASSY	pcs	€ 54
7	1100-2E-3-7	□□□□	Switch assy	pcs	€ 47
8	1100-2E-3-8	□□□□□□	Switch assy cover	pcs	€ -
9	1100-2E-3-9	□□	METER	pcs	€ 126
10	1100-2E-3-10	□□□□□□□□	speedo meter sensor and harness	set	€ 29
11	1100-2E-3-11	□□□□□	HARNESS WIRE	set	€ 326
12	1100-2E-3-12	□□	BATTERY ASSY	pcs	€ 224
13	1100-2E-3-13	□□□□□□□EEC□	RR.L/R. TURNING LIGHT ASSY	set	€ 36
14	1100-2E-3-14	□□□□EEC□		pcs	€ 4
15	1100-2E-3-15	□□□EEC□	TAIL LIGHT ASSY□EEC□	pcs	€ 31
16	1100-2E-3-16	□□□□EEC□	License light	pcs	€ 9
17	1100-2E-3-17	□□□□□□	IGNITION SWITCH ASSY	set	€ 44
18	1100-2E-3-18	□□□□	Mains power switch	set	€ 42

Figure 4

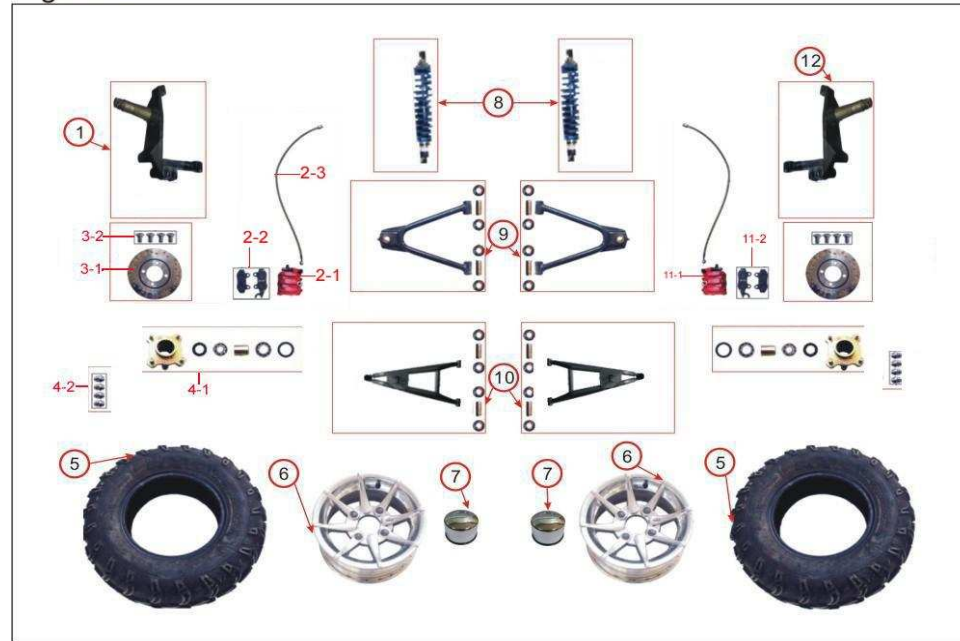

	PART#	CHINESE NAME		STANDARD PART	unit	PUBLIC EURO TTC
1	1100-2E-4-1	□□□□	L.FR.TRIFURCATE SHAFT		pcs	€ 121
2	1100-2E-4-2-1	□□□□□□	L.FR.HYDRAULIC BRAKE PUMP	□□□□	pcs	€ 59
	1100-2E-4-2-2	□□□□□□	Fr./L brake shoe		set	€ 29
	1100-2E-4-2-3	□□□□□	Fr. Brake hose		pcs	€ 27
3	1100-2E-4-3-1	□□□□	FR.BRAKE DISC		pcs	€ 29
	1100-2E-4-3-2	□□□□□□□□	FR.brake disc bolt		pcs	€ 2
4	1100-2E-4-4-1	□□□□□	FR.WHEEL HUB ASSY	□□□4□□□2□□□6204□□	set	€ 110
	1100-2E-4-4-2	□□□□□□	Cat nut M10		pcs	€ 4
5	1100-2E-4-5	□□□25*8-12	FR.TIRE 25*8-12		pcs	€ 126
6	1100-2E-4-6	□□□□	FR.RIM12*6	□□□□	pcs	€ 157
7	1100-2E-4-7	□□□	hub cover		pcs	€ 13
8	1100-2E-4-8	□□□□	FR.SHOCK ABSORBER		pcs	€ 114
9	1100-2E-4-9	□□□□□□	FR.UPPER SWING ARM ASSY	□□□□□□□□□□□□	pcs	€ 89
10	1100-2E-4-10	□□□□□□	FR.LOWER SWING ARM ASSY	□□□□□□□□□□□□	pcs	€ 157
11	1100-2E-4-11-1	□□□□□□	R.FR.HYDRAULIC BRAKE PUMP	□□□□	pcs	€ 39
	1100-2E-4-11-2	□□□□□□	Fr./R brake shoe		set	€ 19
12	1100-2E-4-12	□□□□	R.FR.TRIFURCATE SHAFT		pcs	€ 121

Figure 5

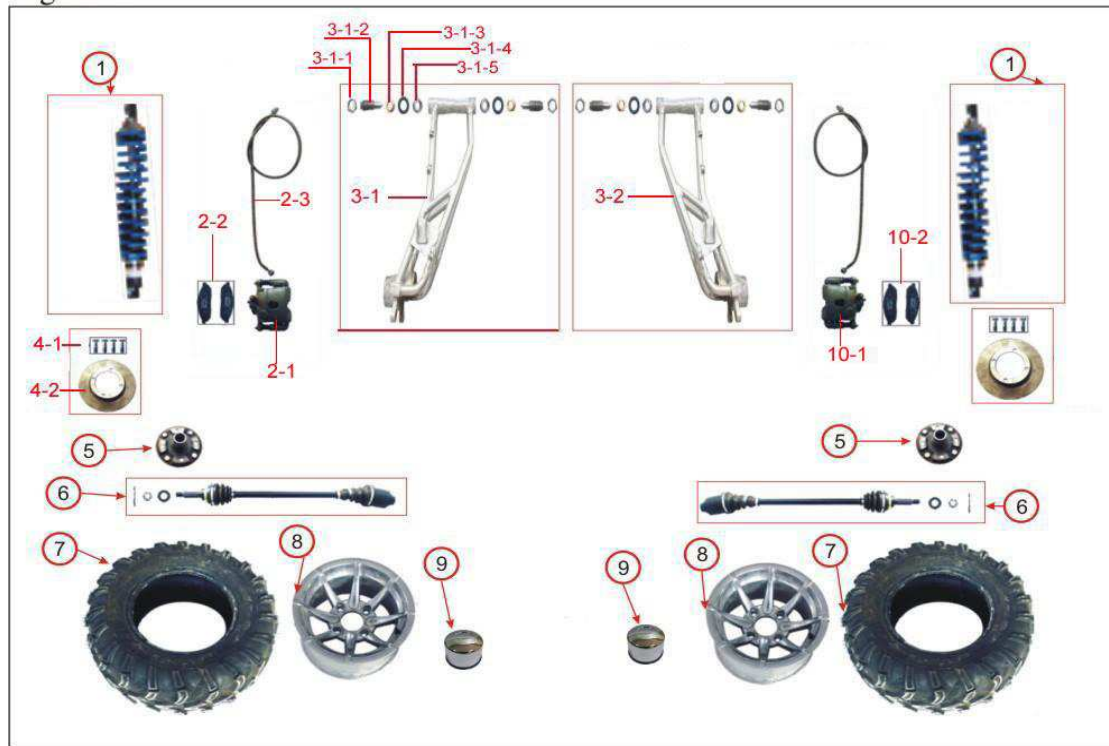

	PART#	CHINESE NAME		STANDARD PART	unit	PUBLIC EURO TTC
1	1100-2E-5-1	□□□□	RR.SHOCK ABSORBER ASSY		pcs	€ 119
2	1100-2E-5-2-1	□□□□□□EEC□□□	L.RR.HYDRAULIC BRAKE PUMP		pcs	€ 206
	1100-2E-5-2-2	□□□□□□	Re./L brake shoe		set	€ 29
	1100-2E-5-2-3	□□□□□	Re. Brake hose		pcs	€ 39
3	1100-2E-5-3-1	□□□□	L.RR.SWING ARM		pcs	€ 188
	1100-2E-5-3-1-1	□□□□□	Nut,RR.SWING ARM		pcs	€ 6
	1100-2E-5-3-1-2	□□□□□	Bolt,RR.SWING ARM		pcs	€ 12
	1100-2E-5-3-1-3	□□25*40*7	Oil seal 25*40*7		pcs	€ 4
	1100-2E-5-3-1-4	□□30203	Bearing 30203		pcs	€ 10
	1100-2E-5-3-1-5	□□□□□□□	Washer,RR.SWING ARM		pcs	€ 4
		□□6007-2Z	Bearing 6007-2Z		pcs	€ 9
	1100-2E-5-3-2	□□□□	R.RR.SWING ARM		pcs	€ 188
4	1100-2E-5-4-1	□□□□□□	Bolt,RR.BRAKE DISC		pcs	€ 2
	1100-2E-5-4-2	□□□□	RR.BRAKE DISC		pcs	€ 41
5	1100-2E-5-5	□□□□□□	RR.WHEEL HUB	□□□4	pcs	€ 47
6	1100-2E-5-6	□□□□	RR.TRANSMISSION SHAFT		pcs	€ 209
7	1100-2E-5-7	□□□25*10-12	RR.TIRE 25*10-12		pcs	€ 142
8	1100-2E-5-8	□□□□	RR.RIM	□□□□	pcs	€ 209
9	1100-2E-5-9	□□□	hub cover		pcs	€ 13
10	1100-2E-5-10-1	□□□□□□(EEC □□□	R.RR.HYDRAULIC BRAKE PUMP		pcs	€ 206
	1100-2E-5-10-2	□□□□□□	Re./R brake shoe		set	€ 29

Figure 6



	PART#	CHINESE NAME		STANDARD PART	unit	PUBLIC EURO TTC
1	1100-2E-6-1	□□	SEAT		pcs	€ 200
2	1100-2E-6-2	□□□	SAFE BELT		pc	€ 42
3	1100-2E-6-3	□□□□□□	BRACKET & ADJUSTER,SEAT		set	€ 43

Figure 7

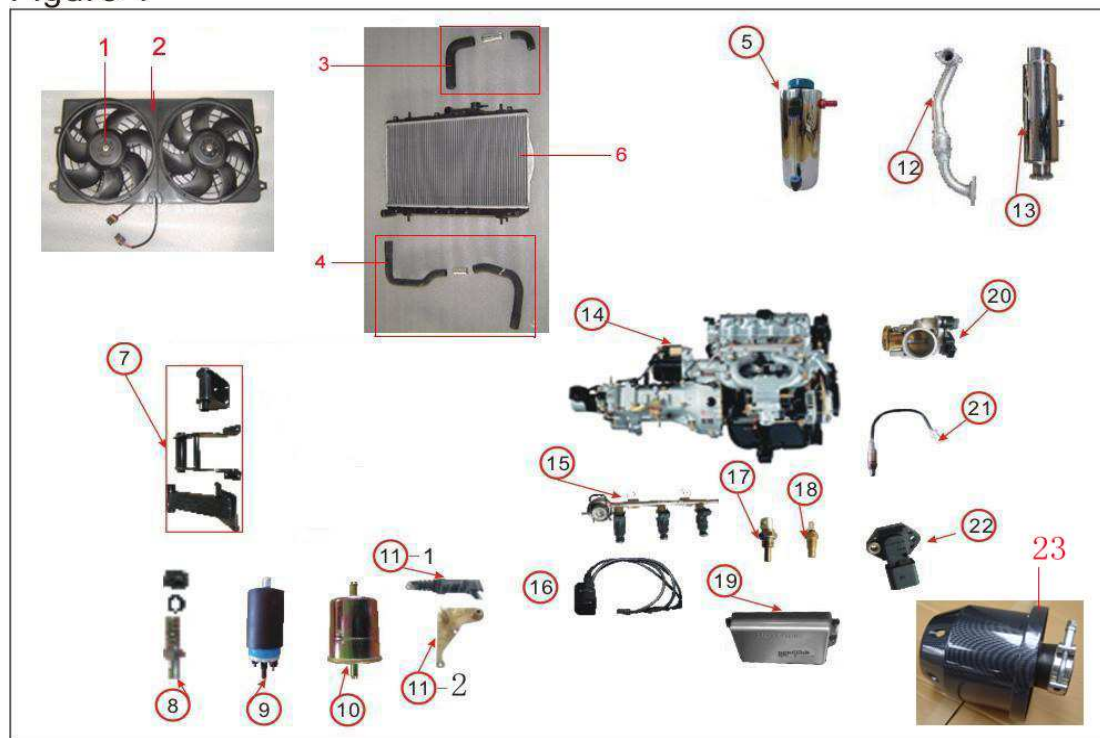

	PART#	CHINESE NAME		STANDARD PART	unit	PUBLIC EURO TTC
1	1100-2E-7-1	□□	Fan		set	€ 283
2	1100-2E-7-2	□□□	Fan cover			€ -
3	1100-2E-7-3	□□□□□	water pipe (□)		set	€ 68
4	1100-2E-7-4	□□□□□	water pipe (□)		set	€ 68
5	1100-2E-7-5	□□□	WATER TANK		pcs	€ 77
6	1100-2E-7-6	□□□□□□□□	RADIATOR (DOUBLE FAN)		pcs	€ 201
7	1100-2E-7-7	□□□□□	engine bracket		pcs	€ 245
8	1100-2E-7-8	□□□□□	Fuel tank joint		set	€ 9
9	1100-2E-7-9	□□□	Fuel pumper		pcs	€ 115
10	1100-2E-7-10	□□□□□	fuel filter		pcs	€ 21
11	1100-2E-7-11-1	□□□□□	smaller clutch pumper		pcs	€ 38
	1100-2E-7-11-2	□□□□□	smaller clutch pumper bracket		pcs	€ 42
12	1100-2E-7-12	□□□□	exhaust		pcs	€ 334
13	1100-2E-7-13	□□□□	muffler		pcs	€ 218
14	1100-2E-7-14	□□□□	engine		pcs	€ -
15	1100-2E-7-15	□□□□□	oil rail assy		pcs	€ 571
16	1100-2E-7-16	□□□□□	ignition coil		pcs	€ 137
17	1100-2E-7-17	□□□□□□□ECU□	water temperature sensor (ECU)		pcs	€ 36
18	1100-2E-7-18	□□□□□□□□□□	water temperature sensor(meter)		pcs	€ 12
19	1100-2E-7-19	□□□□□□□	ECU		pcs	€ 629
20	1100-2E-7-20	□□□□□□□□□□□□□□□□□□	Throttle Body (ISCV & TPS)		pcs	€ 296
21	1100-2E-7-21	□□□□□	oxygen sensor		pcs	€ 138
22	1100-2E-7-22	□□□□□□□□	temperature pressure sensor		pcs	€ 114
25	1100-2E-7-23	□□□□	air filter		pcs	€ 41
23		□□□□□□	CLUTCH PRESSURE PLATE ASSY	LJ465Q-1ANE1-1601000	pcs	€ 98
24		□□□□□□□	CLUTCH FRICTION DISC ASSY	LJ465Q-1ANE1-1602000	pcs	€ 72