

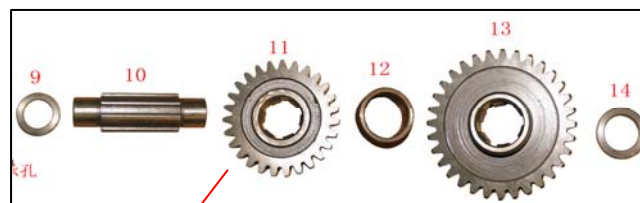

输出轴组件

Output shaft assembly



中间轴组件

Intermediate shaft assembly

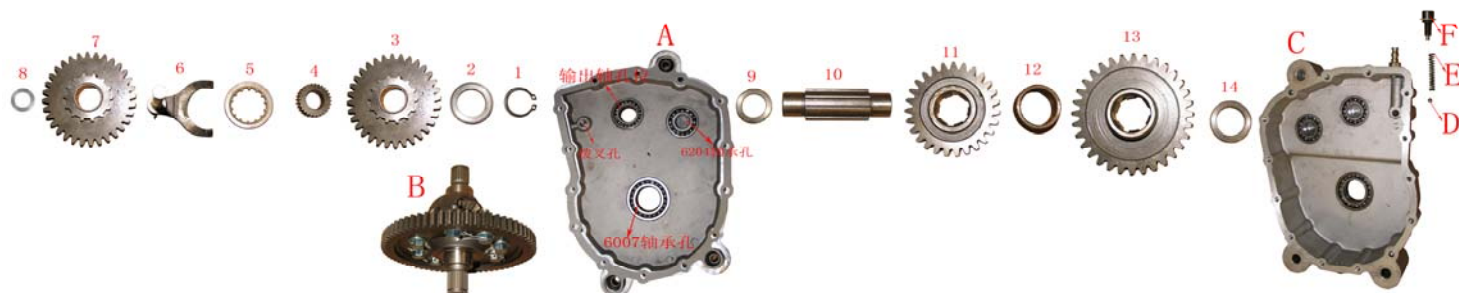

Installation Instruction: 1. The installation of output shaft: please fix A on output shaft of engine; place 1(ϕ 25 clip) on the clip slot ,then install 2 (concave washer) (note: concave side facing the clip); install 3 (32T;14T duplicate gear).(note:14T upwards):insert 4 in 5 ,then install it on the output shaft. Install 7(32T;14T duplicate gear)(note:14T downwards) on 8(ϕ 20 flat washer).put 6 (shifting yoke) into corresponding gear 5 and the yoke hole.

· The installation of intermediate shaft : install intermediate shaft (10) and 9(ϕ 20 flat washer) into the bearing hole (6204) of gear box cover .then install 11, 12(liner tube), 13 (32T gear) (note: facing downwards) and 14 (ϕ 20 flat washer).

·To install B (Differential mechanism) into the hole of 6007 bearing in the gear box cover.

· Check and make sure the fixing pin M8*14 and the 2 sealing gaskets in good condition, and then close the gear box body and fasten the bolts.

·Install D (Fixing steel ball).E (spring) and F (bolt) into the respective holes.